

RIDDIFORD STREET - PART 1

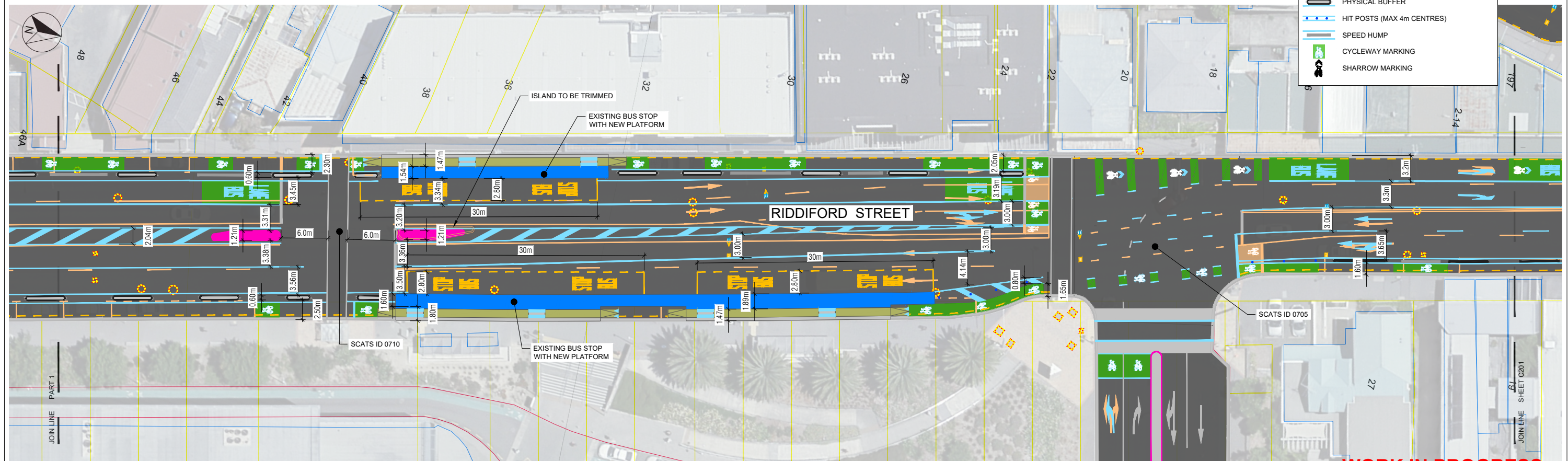

RIDDIFORD STREET - PART 2

WORK IN PROGRESS
PRINTED 28/01/2022 4:55:26 PM

1:250 @ A1
1:500 @ A3

REVISION	AMENDMENT	APPROVED	DATE
A	FOR INFORMATION AND CLIENT REVIEW	CG	2021-10-15
B	FOR INFORMATION AND CLIENT REVIEW	cg	2022-01-28



wsp
Wellington Office
+64 4 471 7000

PO Box 12-003
Wellington 6144
New Zealand

CIVIL - URBAN DESIGN

SCALES
1:250 (A1), 1:500 (A3)
A1

DRAWN P. MANI	DESIGNED U. GABRIEL	APPROVED C. GROOM
DRAWING VERIFIED R. BATTY	DESIGN VERIFIED R. BATTY	APPROVED DATE 2021-12-15

90% CONCEPT DESIGN

PROJECT
**WELLINGTON CITY COUNCIL
NEWTOWN TO WATERFRONT
CYCLEWAY**

TITLE
**RIDDIFORD STREET TO ADELAIDE ROAD
GENERAL LAYOUT PLAN - SHEET 1 OF 4**

WSP PROJECT NO. (SUB-PROJECT)
5-C4623.00(1)

SHEET NO.
C200

REVISION
B

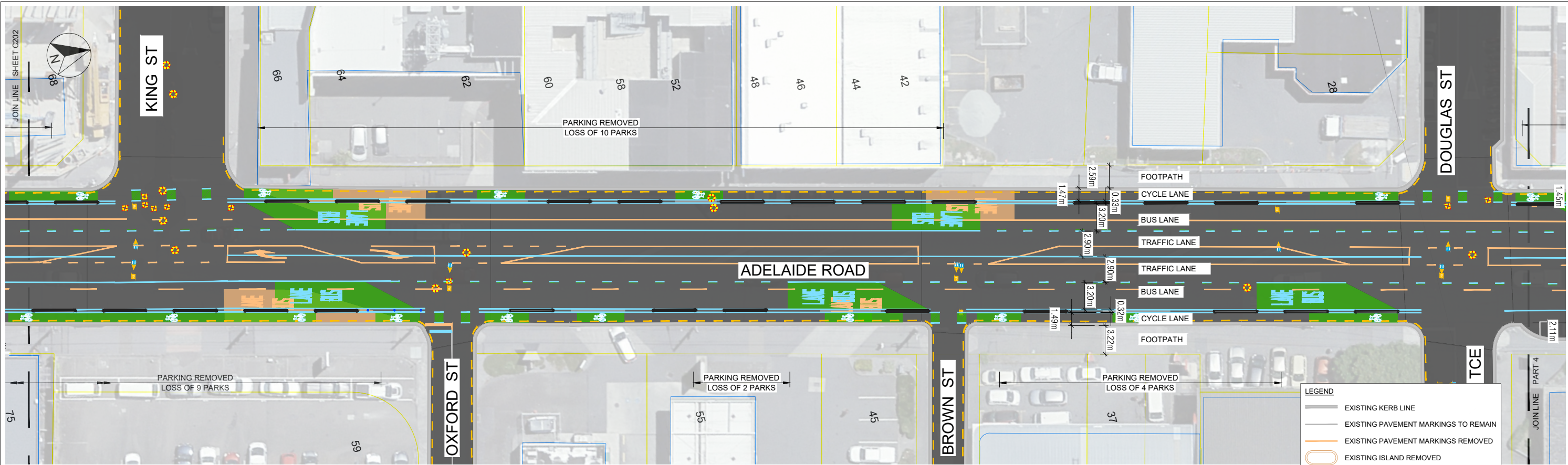

ADELAIDE ROAD - PART 3

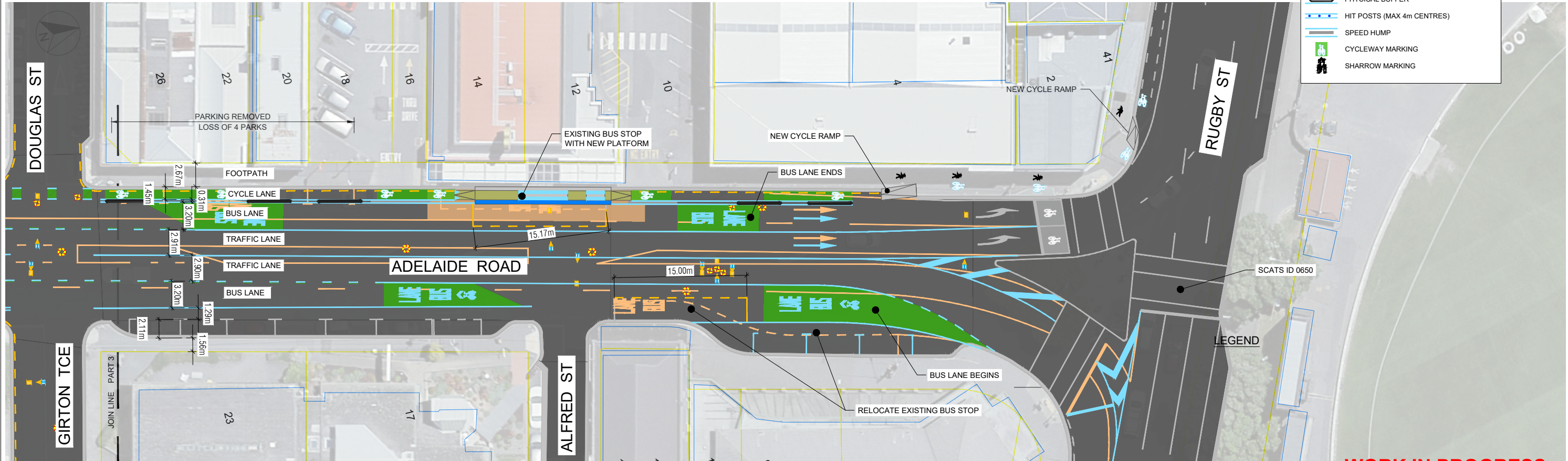

ADELAIDE ROAD - PART 4

WORK IN PROGRESS
PRINTED 28/01/2022 4:58:49 PM

REVISION	AMENDMENT	APPROVED	DATE
A	FOR INFORMATION AND CLIENT REVIEW	CG	2021-12-15
B	FOR INFORMATION AND CLIENT REVIEW	CG	2022-01-28



CIVIL - URBAN DESIGN

SCALES	DESIGNED	APPROVED
1:250 (A1), 1:500 (A3)	U. GABRIEL	C. GROOM
DRAWN	P. MANI	APPROVED DATE
DRAWING VERIFIED	R. BATTY	2021-12-15

90% CONCEPT DESIGN

PROJECT	WELLINGTON CITY COUNCIL NEWTOWN TO WATERFRONT CYCLEWAY
TITLE	RIDDIFORD STREET TO ADELAIDE ROAD GENERAL LAYOUT PLAN - SHEET 4 OF 4
WSP PROJECT NO. (SUB-PROJECT)	5-C4623.00(1)
SHEET NO.	C203
REVISION	B

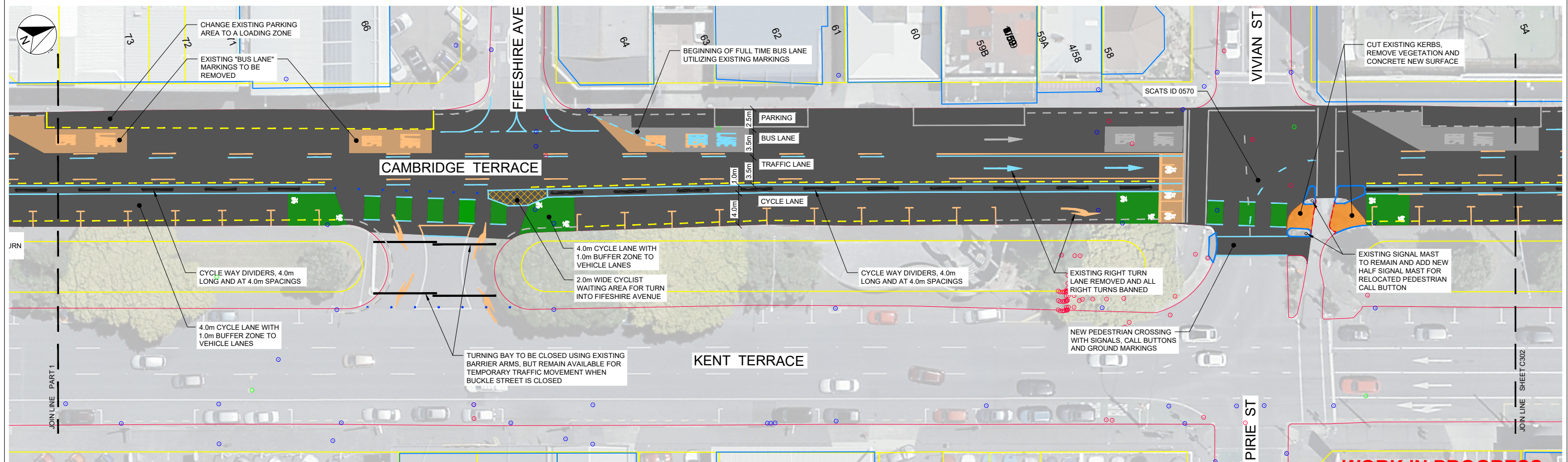
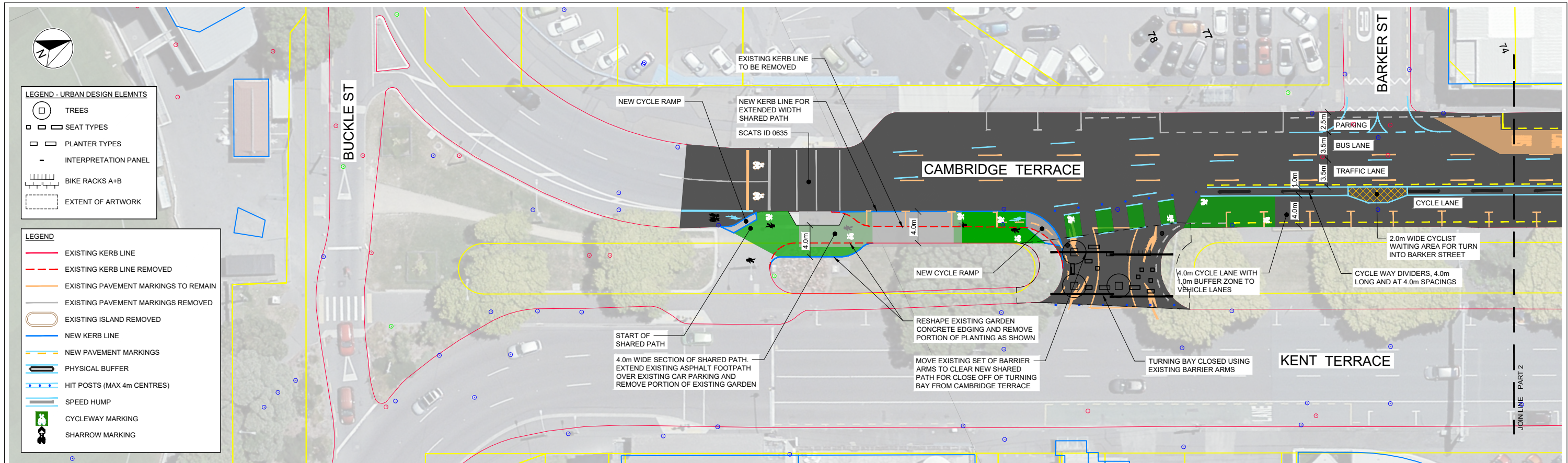

WORK IN PROGRESS
PRINTED 28/01/2022 5:01:10 PM

1:250 @ A1
1:500 @ A3

REVISION	AMENDMENT	APPROVED	DATE
A	FOR INFORMATION AND CLIENT REVIEW		2021-12-15
B	FOR INFORMATION AND CLIENT REVIEW	CG	2022-01-28

Absolutely Positively
Wellington City Council
Me Heke Ki Pōneke

wsp
Wellington Office
+64 4 471 7000
PO Box 12-003
Wellington 6144
New Zealand
CIVIL - URBAN DESIGN

SCALES
1:250 (A1), 1:500 (A3)
ORIGINAL SIZE
A1
DRAWN
W.EATON
DESIGNED
APPROVED
DRAWING VERIFIED
DESIGN VERIFIED
APPROVED DATE
2021-10-XX
90% CONCEPT DESIGN

PROJECT
WELLINGTON CITY COUNCIL
NEWTOWN TO WATERFRONT
CYCLEWAY
TITLE
CAMBRIDGE TERRACE - BASIN RESERVE TO ORIENTAL PARADE
LAYOUT PLAN - SHEET 1 OF 3
WSP PROJECT NO. (SUB-PROJECT)
5-C4623.00(1)
SHEET NO.
C301
REVISION
B

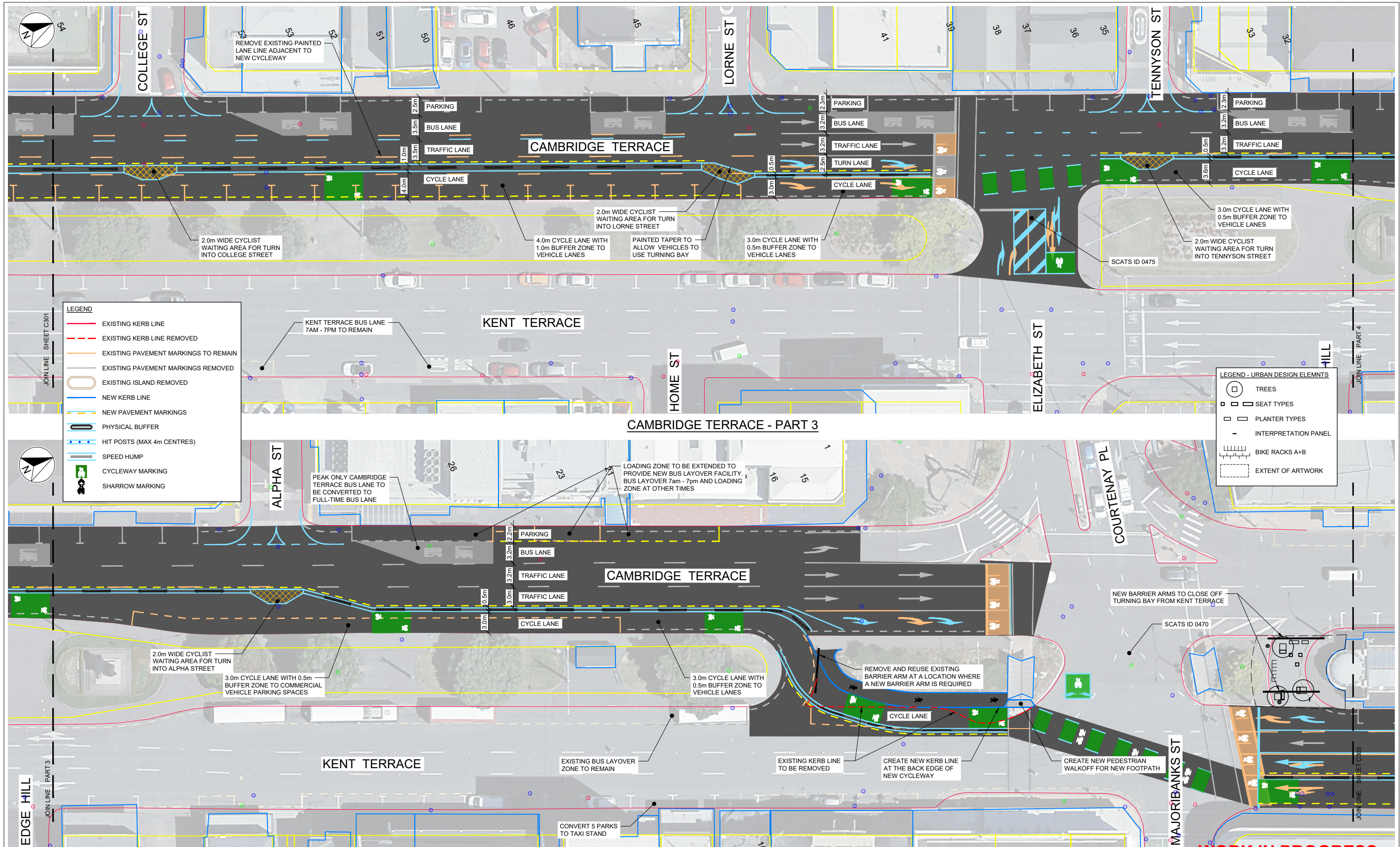

WORK IN PROGRESS
PRINTED 28/01/2022 5:01:58 PM

1:250 @ A1
1:500 @ A3

REVISION	AMENDMENT	APPROVED	DATE
A	FOR INFORMATION AND CLIENT REVIEW		2021-12-15
B	FOR INFORMATION AND CLIENT REVIEW	CG	2022-01-28





Wellington Office
+64 4 471 7000

PO Box 12-003
Wellington 6144
New Zealand

CIVIL - URBAN DESIGN

SCALES
1:250 (A1), 1:500 (A3)

ORIGINAL SIZE
A1

DRAWN W.EATON	DESIGNED	APPROVED
DRAWING VERIFIED	DESIGN VERIFIED	APPROVED DATE 2021-10-XX

90% CONCEPT DESIGN

PROJECT
**WELLINGTON CITY COUNCIL
NEWTOWN TO WATERFRONT
CYCLEWAY**

TITLE
**CAMBRIDGE TERRACE - BASIN RESERVE TO ORIENTAL PARADE
LAYOUT PLAN - SHEET 2 OF 3**

WSP PROJECT NO. (SUB-PROJECT)
5-C4623.00(1)

SHEET NO.
C302

REVISION
B

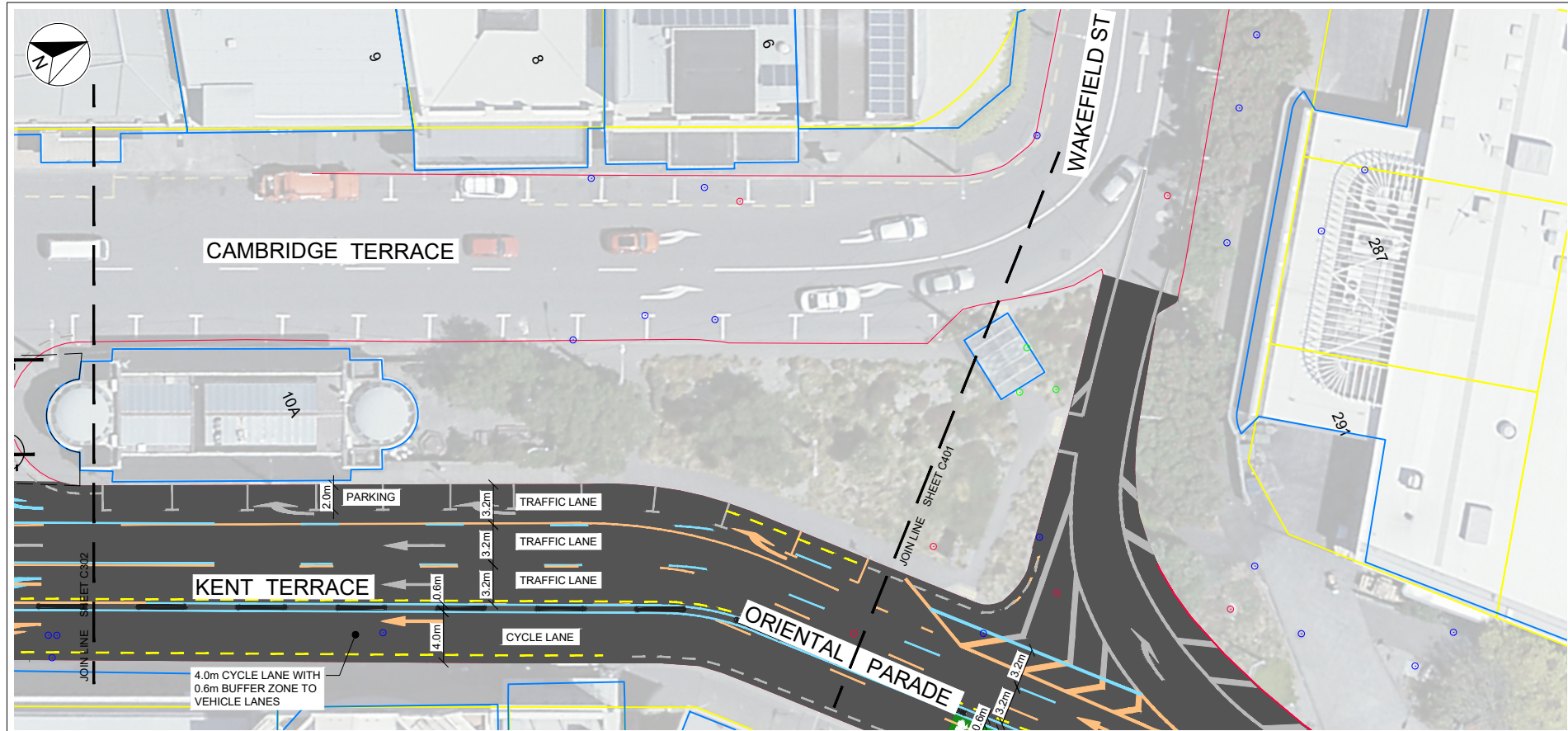

CAMBRIDGE TERRACE - PART 5

LEGEND

- EXISTING KERB LINE
- EXISTING KERB LINE REMOVED
- EXISTING PAVEMENT MARKINGS TO REMAIN
- EXISTING PAVEMENT MARKINGS REMOVED
- EXISTING ISLAND REMOVED
- NEW KERB LINE
- NEW PAVEMENT MARKINGS
- PHYSICAL BUFFER
- HIT POSTS (MAX 4m CENTRES)
- SPEED HUMP
- CYCLEWAY MARKING
- SHARROW MARKING

LEGEND - URBAN DESIGN ELEMNTS

- TREES
- SEAT TYPES
- PLANTER TYPES
- INTERPRETATION PANEL
- BIKE RACKS A+B
- EXTENT OF ARTWORK

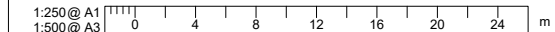

REVISION	AMENDMENT	APPROVED	DATE
A	FOR INFORMATION AND CLIENT REVIEW		2021-12-15
B	FOR INFORMATION AND CLIENT REVIEW	CG	2022-01-28



Wellington Office
+64 4 471 7000

PO Box 12-003
Wellington 6144
New Zealand

CIVIL - URBAN DESIGN

SCALES			ORIGINAL SIZE
1:250 (A1), 1:500 (A3)			A1
DRAWN	DESIGNED	APPROVED	
W.EATON			
DRAWING VERIFIED	DESIGN VERIFIED	APPROVED DATE	
		2021-10-XX	

90% CONCEPT DESIGN

PROJECT		
WELLINGTON CITY COUNCIL NEWTOWN TO WATERFRONT CYCLEWAY		
TITLE		
CAMBRIDGE TERRACE - BASIN RESERVE TO ORIENTAL PARADE LAYOUT PLAN - SHEET 3 OF 3		
WSP PROJECT NO. (SUB-PROJECT)	SHEET NO.	REVISION
5-C4623.00(1)	C303	B

WORK IN PROGRESS
PRINTED 28/01/2022 5:02:22 PM

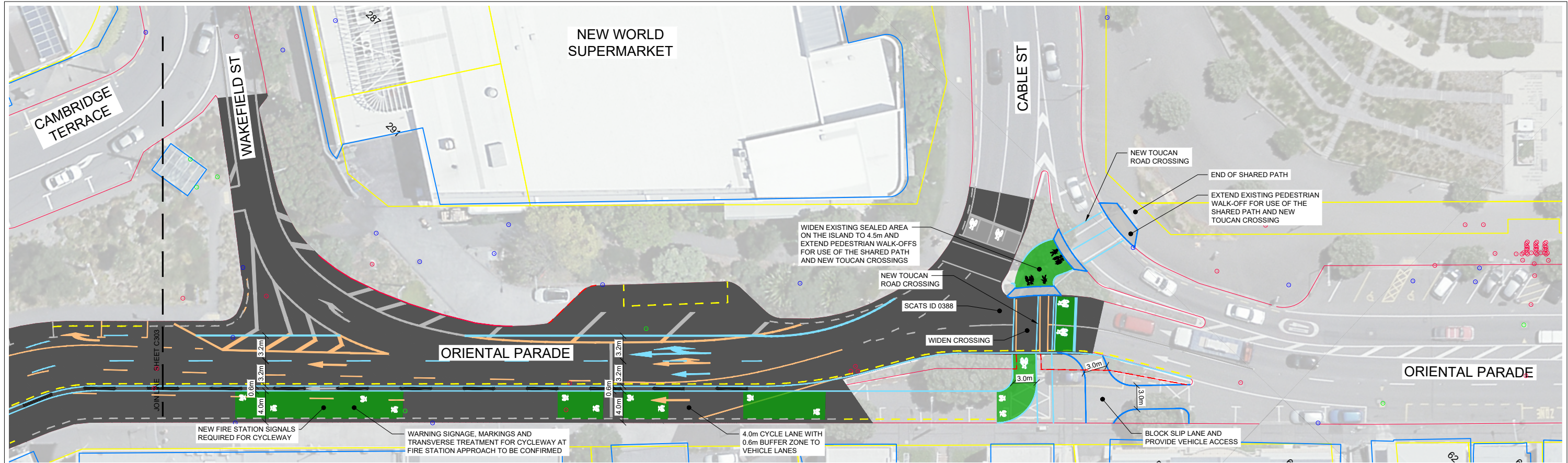

ORIENTAL PARADE - PART 1

LEGEND

- EXISTING KERB LINE
- EXISTING KERB LINE REMOVED
- EXISTING PAVEMENT MARKINGS TO REMAIN
- EXISTING PAVEMENT MARKINGS REMOVED
- EXISTING ISLAND REMOVED
- NEW KERB LINE
- NEW PAVEMENT MARKINGS
- PHYSICAL BUFFER
- HIT POSTS (MAX 4m CENTRES)
- SPEED HUMP
- CYCLEWAY MARKING
- SHARROW MARKING

LEGEND - URBAN DESIGN ELEMNTS

- TREES
- SEAT TYPES
- PLANTER TYPES
- INTERPRETATION PANEL
- BIKE RACKS A+B
- EXTENT OF ARTWORK

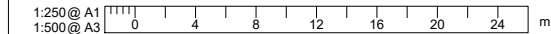

REVISION	AMENDMENT	APPROVED	DATE
A	FOR INFORMATION AND CLIENT REVIEW		2021-12-15
B	FOR INFORMATION AND CLIENT REVIEW	CG	2022-01-28



Wellington Office
+64 4 471 7000

PO Box 12-003
Wellington 6144
New Zealand

CIVIL - URBAN DESIGN

SCALES			ORIGINAL SIZE
1:250 (A1), 1:500 (A3)			A1
DRAWN	DESIGNED	APPROVED	
W.EATON			
DRAWING VERIFIED	DESIGN VERIFIED	APPROVED DATE	
		2021-10-XX	

90% CONCEPT DESIGN

WORK IN PROGRESS

PRINTED 28/01/2022 5:37:57 PM

PROJECT
WELLINGTON CITY COUNCIL
NEWTOWN TO WATERFRONT
CYCLEWAY

TITLE
ORIENTAL PARADE - CAMBRIDGE TERRACE TO WATERFRONT
LAYOUT PLAN - SHEET 1 OF 1

WSP PROJECT NO. (SUB-PROJECT)
5-C4623.00(1)

SHEET NO.
C401

REVISION
B